

SBL 22-12HR

(12V 666W)

Nominal voltage	12 V	
Nominal capacity	666 W / 10min to 1,67 V/cell 22 Ah @ C20 to 1,75 V/cell	
Dimensions	Length	181 mm
	Width	77 mm
	Height / Total height	167 / 167 mm
Weight	~ 6,3 kg	
Technology	VRLA (Valve Regulated Lead Acid) AGM (Absorbent Glass Mat)	
Design life time	10-12 years (standby use)	
Internal resistance	~ 10,0 mΩ (full charged)	
Operating temperature range	Discharge	-20°C ~ +60°C
	Charge	0°C ~ +50°C
	Storage	-20°C ~ +60°C
Maximum discharge current	220 A (5 sec.)	
Short circuit current	920 A	
Recommended maximum charging current	6,6 A	
Charging voltage	Standby use	13,7 ~ 13,9 VDC
	Cycle use	14,6 ~ 14,8 VDC
Self discharge	Monthly is less than 3% at 25°C	
Container material	ABS UL94HB (optional UL94-V0)	
Terminal types	Internal thread M5 (breaking torque 6-7 Nm)	

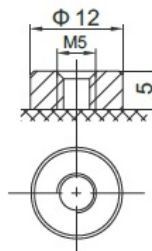
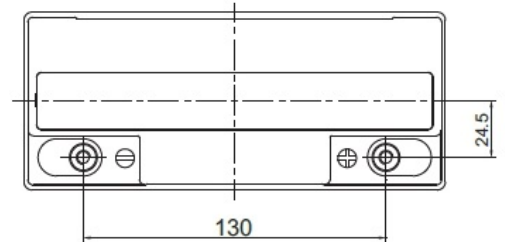
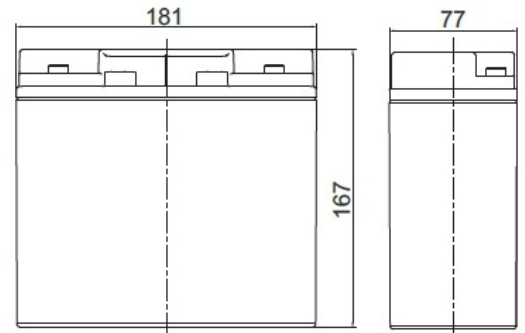

CONSTANT CURRENT DISCHARGE CHARACTERISTICS (A at 25°C)

Voltage / Time	5 min	8 min	10 min	15 min	20 min	30 min	60 min	90 min
9.6 V	86,17	71,64	63,21	49,86	40,36	29,55	17,23	12,56
10.0 V	79,74	67,21	59,31	47,26	37,65	28,17	16,42	11,96
10.2 V	76,42	64,84	57,16	45,81	36,21	27,37	15,95	11,60
10.5 V	72,18	61,60	53,68	43,66	35,22	26,60	15,69	11,34
10.8 V	67,89	58,36	50,17	41,47	34,18	25,79	15,38	11,06
11.1 V	63,36	54,87	46,51	39,11	32,98	24,83	15,01	10,73

CONSTANT POWER DISCHARGE CHARACTERISTICS (W at 25°C)

Voltage / Time	5 min	8 min	10 min	15 min	20 min	30 min	60 min	90 min
9.6 V	936	792	702	556,2	445,2	326,4	191,4	139,8
10.0 V	876	750	666	532,8	419,4	314,4	184,2	134,4
10.2 V	846	732	648	522,0	408,0	309,0	180,6	132,0
10.5 V	810	702	618	504,0	402,0	304,2	180,0	130,8
10.8 V	774	678	584,4	486,0	395,4	299,4	178,8	129,6
11.1 V	738	648	552,6	467,4	389,4	294,0	178,2	127,8

According with:

PN-EN 60896-21:2007	ISO 9001
PN-EN 60896-22:2007	ISO 14001
PN-EN 61056-1:2013	
PN-EN 61056-2:2013	
PN-E-83016:1999	

EFFECT OF TEMPERATURE ON LONG TERM LIFE

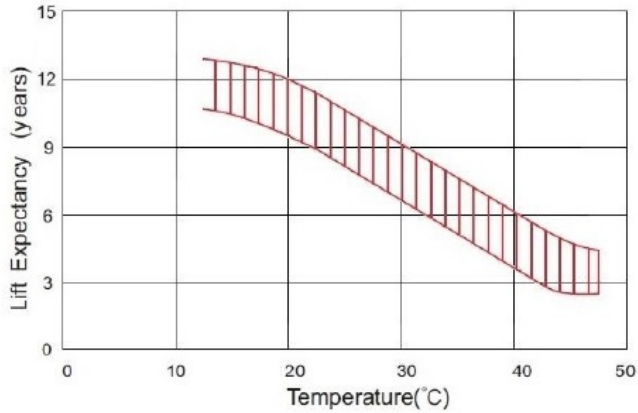

CYCLE LIFE IN RELATION TO DEPTH OF DISCHARGE

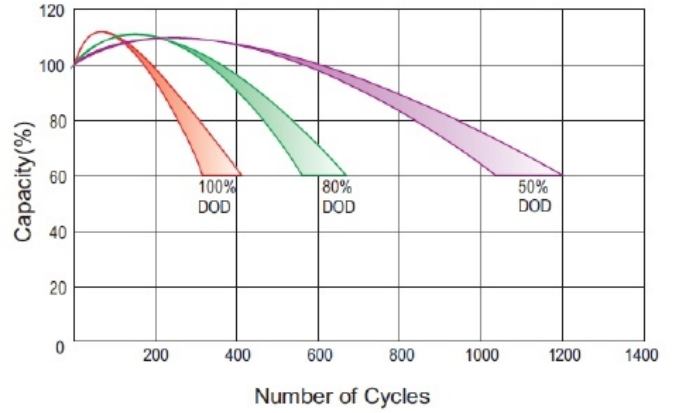

DISCHARGE CHARACTERISTICS

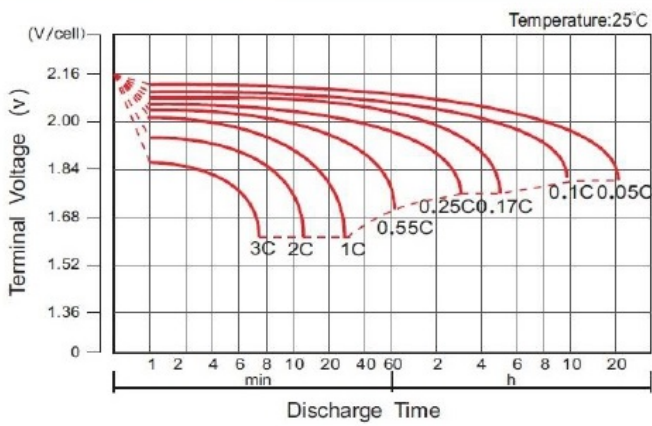

CHARGE CHARACTERISTIC FOR STANDBY USE

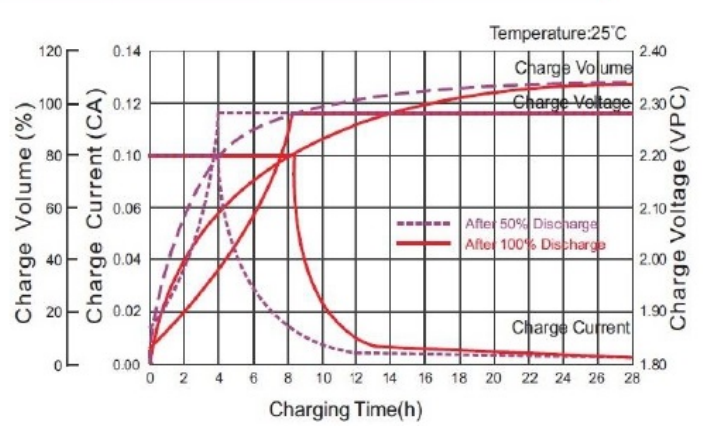

RELATIONSHIP BETWEEN CHARGING VOLTAGE AND TEMPERATURE

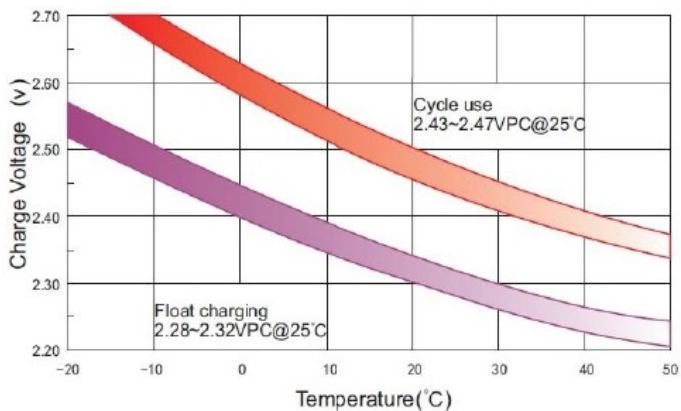

STORAGE CHARACTERISTICS

